

WaterSystems

SPHE Series



Applications

Ideal for both residential and commercial lawn and turf sprinkler systems.

Features

- **CASING AND SEAL PLATE** - Built from rugged cast iron.
- **SHAFT SEAL** – Standard 5/8" rotating mechanical seal, for a reliable seal against water leakage.
- **IMPELLER** – Precision molded glass filled thermoplastic is extra smooth, for highest pump efficiency and longevity.
- **REPLACEABLE DIFFUSER** – Glass filled engineered thermoplastic, can be serviced easily and inexpensively to maintain high pump efficiency.
- **SUCTION** – 2" NPT Suction.
- **DISCHARGE** – 1½" NPT Discharge.
- **DRAINING PLUG** – For easy drainage of pump.
- **PRIMING PLUG** – To facilitate rapid priming.
- **O-RING CASING SEAL** – For positive seal and ease of service.
- **BRASS WEAR RING** – Installed in diffuser to maximize hydraulic pump efficiency.
- **O-RING CASING SEAL** – For positive seal and ease of service.
- **BRASS WEAR RING** – Installed in diffuser to maximize hydraulic pump efficiency.
- **MOTOR** – Single phase capacitor start, 115/230 volt with **higher than NEMA service factors**. Stainless Steel motor shaft for corrosion resistance.

Dimensional Outline

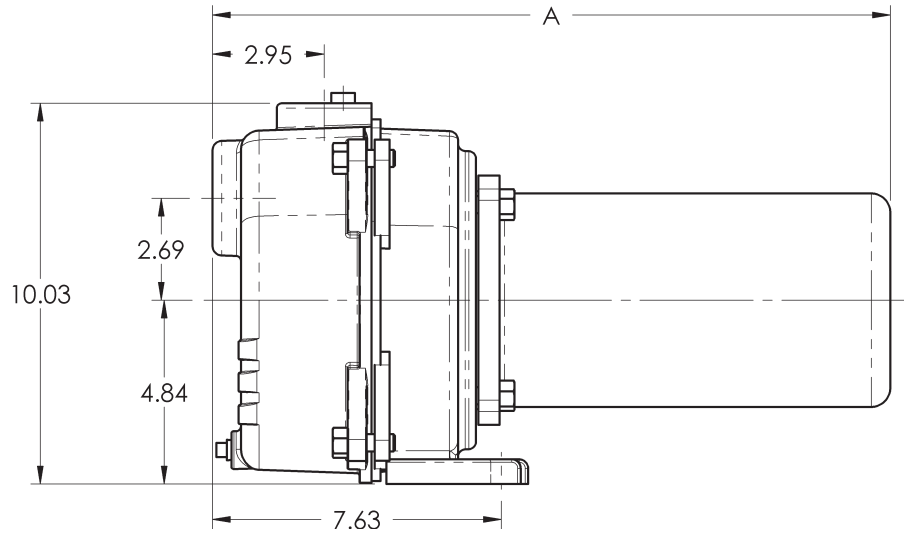
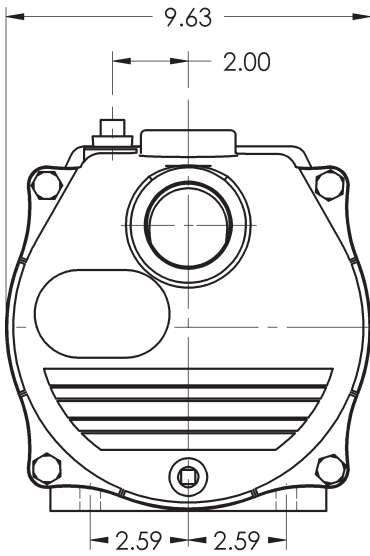

"A" Dimensions	
SPHE-S75	10.88"
SPHE-S100	11.88"
SPHE-S150	12.63"
SPHE-S200	12.65"

LSP-100-C	18.9"
LSP-150-C	19.5"
LSP-200-C	21.0"

*Dimensions measured in inches

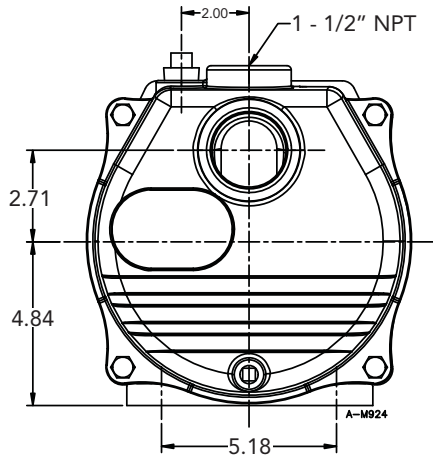
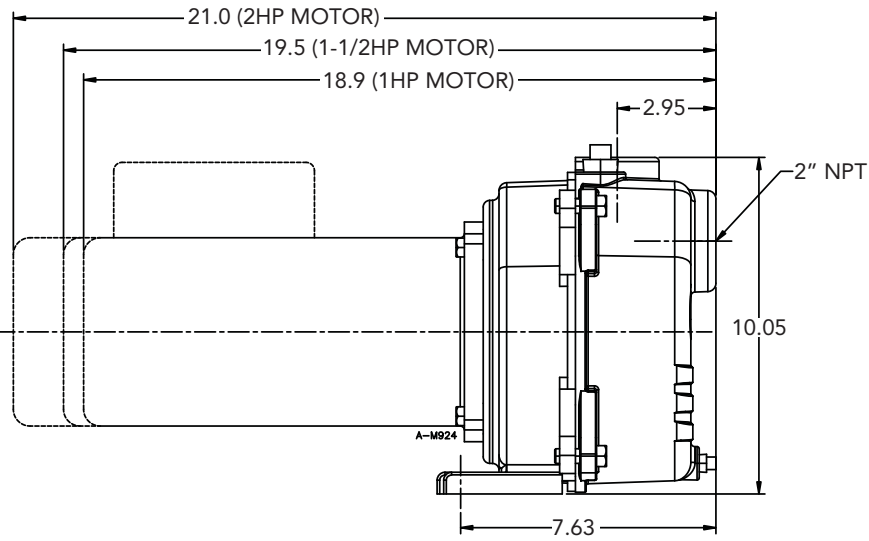

Specifications

Model No.	Item No.	Little Giant Item No.	Listing	HP	SF	Suct. NPT	Volts	Discharge	Discharge Pressure in PSI at 5 ft. Lift					Max. PSI	Ship Wt. (lbs.)
									10	20	30	40	50		
									Capacities in U.S. GPM						
SPHE-S75	614661	-	cCSAus	3/4	14.8/7.4	2"	115/230	1 1/2"	63	52	40	12	33	45	64
SPHE-S100	614662	558294	cCSAus	1	19.2/9.6	2"	115/230	1 1/2"	72	62	46	20	33	46	66
SPHE-S150	614663	558295	cCSAus	1 1/2	24.0/12.0	2"	115/230	1 1/2"	90	80	64	40	33	47	72
SPHE-S200	614664	558296	cCSAus	2	11.2	2"	230	1 1/2"	97	90	74	47	33	48	76
SPHE-S200H	614668	-	cCSAus	2	11.2	2"	230	1 1/2"	84	81	73	58	33	57	76

Performance Curve

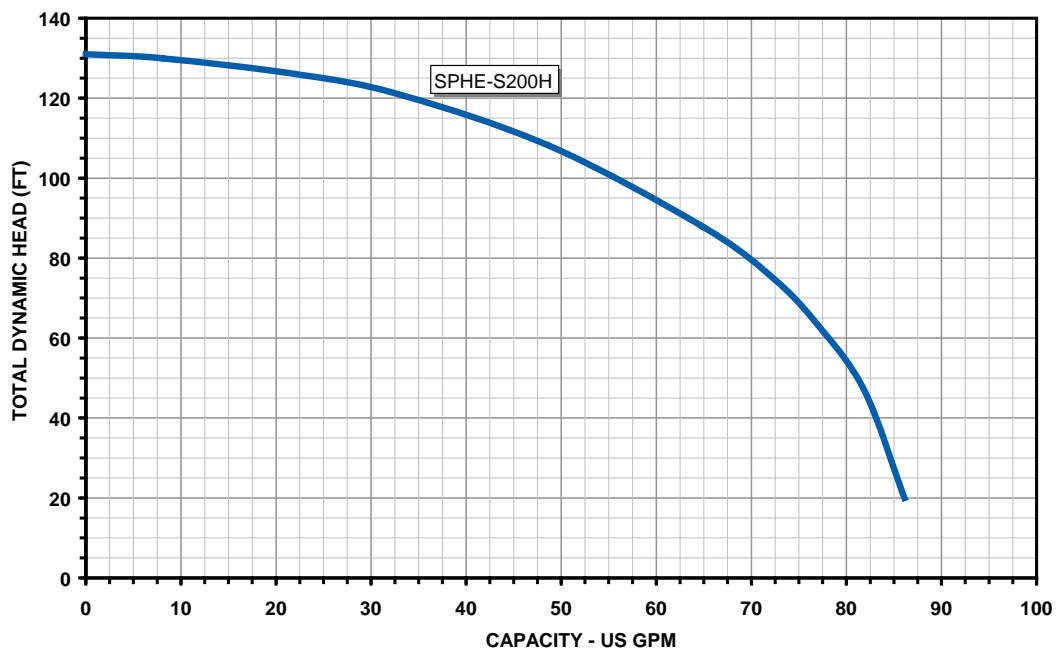
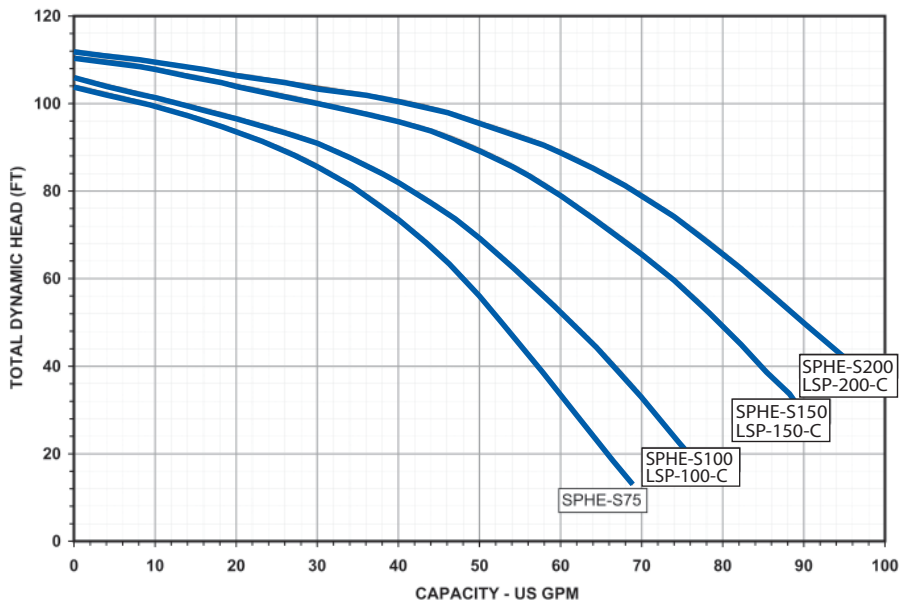



Franklin Electric

P.O. Box 12010
Oklahoma City, OK 73157-2010
Phone: 1.800.701.7894
Fax: 1.800.678.7867
www.LittleGiantPump.com

©2009 Franklin Electric Co., Inc.
Little Giant® is a registered trademark of Franklin Electric Co., Inc.
Form 995730 — 05/09